

**HC-TTB**



- Rated current 300A ~ 900A
- Potted products
- Superior noise-resistance
- Built-in wire break detector enables detection of broken GND connection

**Applications**

Inverters, Servo drivers, Power supply equipment, Uninterruptible power supply (UPS), NC machine tools, Welders

**Dimensions**

(mm)

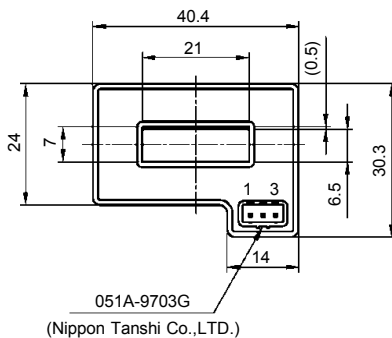

Conformable housing and pin  
 0520-9103 and 17528-M5 (Nippon Tanshi Co.,LTD.)

Terminal No. 1 - (+) terminal  
 2 - Output  
 3 - GND

Weight : 47g

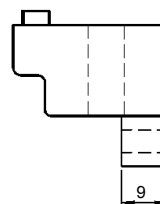
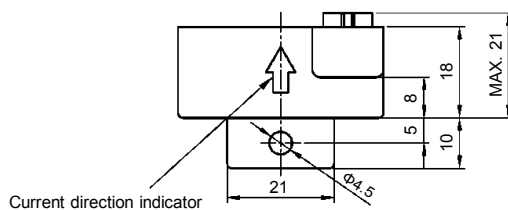

General tolerance: ±0.5

**Specification** Ta=25°C

Type	HC-TTB300V2PP5	HC-TTB600V2PP5	HC-TTB900V2PP5
Rated current [ If ]	±300A	±600A	±900A
Saturation current [ Is ]	±330A	±660A	±990A
Linearity limits	0~±300A	0~±600A	0~±900A
Rated output [ Vh ]	V0±2V±50mV (RL=10kΩ)		
Residual output [ V0 ]	Within Vcc/2±50mV		
Output linearity	Within ±1%		
Response time	Within 10μs (at di/dt=100A/μs)		
Response performance	Within 10%		
Hysteresis voltage range	Within 30mV		
Output Temp. Coef.	Within ±0.1%/°C		
Residual output Temp. Coef.	Within ±1mV/°C		
Control power supply [ Vcc ]	+5V±5%		
Consumption current	Within 30mA		
Operating Temp.	-10°C~+80°C		
Storage Temp.	-15°C~+85°C		
Dielectric withstand voltage	2500V AC 50/60Hz 1minute		
Insulation resistance	Not less than 500MΩ 500V DC		

Note1) The indicated residual output is the one after the core hysteresis is removed.

Note2) Output specifications include 100-Ω output resistance and 0.7-mA maximum output current.

Note3) Since residual output is ratiometric output, it varies according to the control power supply value.

Note4) Output is +4.8 V or greater when GND line is disconnected.

**Characteristics chart** HC-TTB600V2PP5 Time base: 5μs/div.

Pulse current response characteristic

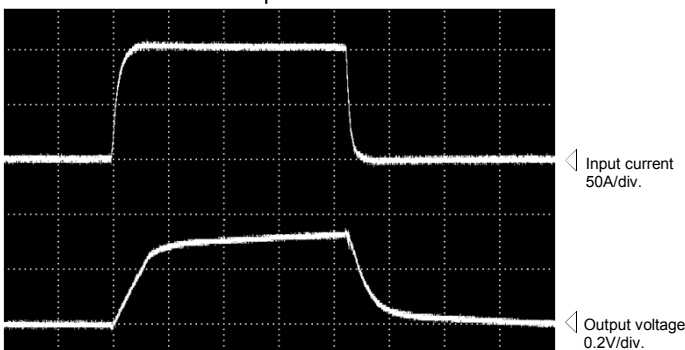

Noise characteristics (Effects of dv/dt)

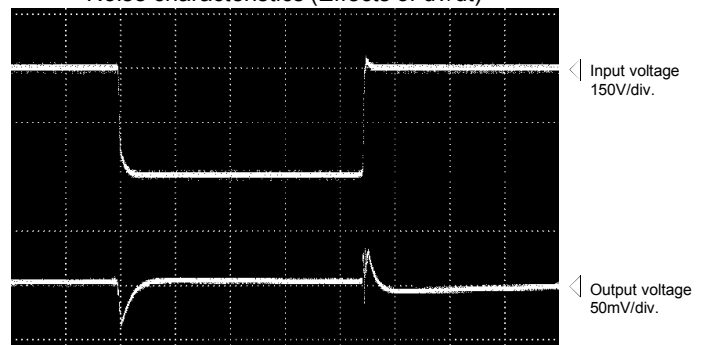

Noise characteristics (Effects of impulse noise)

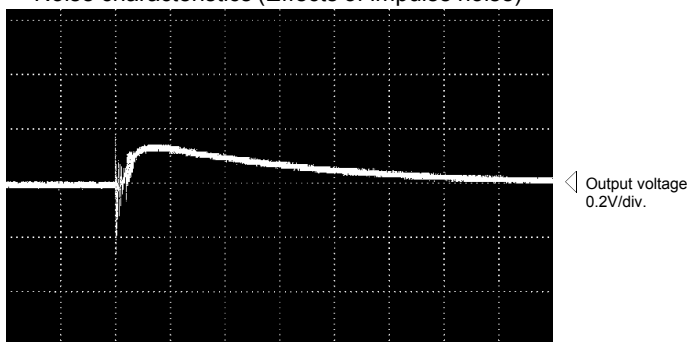

Input/output characteristics Ta=25°C

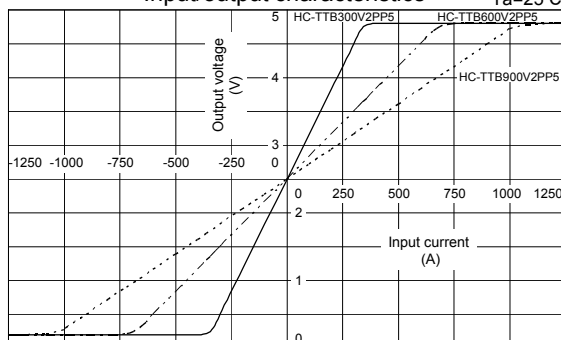

Note: The marks "◁" means 0V or 0A.